

Mobile Chipper 806 ST





Solutions For Customer Satisfaction

Customer satisfaction is the most important target in our daily work. By offering a full customized solution, we can meet the needs to ensure that the chipper fit perfectly with the customer machinery, in order to get the work done.

BRUKS Mobile Chippers are developed and manufactured in Arbrå, which is surrounded by nature and the deep Swedish forests. BRUKS products are designed and built to perform in the toughest environments and climates. High quality and reliability allow you to get the work done. The mobile chippers can be installed onto a carrier vehicle such as a forwarder, a truck or onto a trailer.

In combination with new innovative solutions for production of renewable biomass fuel, our mobile chippers and systems are unique in the process of harvesting the energy material already in the forest. This type of production gives a clean chip with high density, perfect chipping fracture and low moisture grade that ensures high energy content.

BRUKS Mobile is a part of **BRUKS Group**.
www.bruksmobile.com

About this product catalogue

This product catalogue is intended to be used as sales support material and is divided into chapters covering: **Standard Machine, Alternative Equipment, Installation Kits, Optional Equipment and Accessories**. The first part describes components included in the standard specification and its customer values. The alternative equipment part cover components that can be added onto the configuration. The standard component will be replaced by the customized component. There are a number of installation kits described in the chapter Installation Kits. These are installation kits that are tailor made to fit a particular vehicle. The chapter Optional Equipment describes equipment that can be added to the complete configuration such as engine pre-heater, reversing camera etc. The last part cover accessories available for the machine such as knife kits.

By offering a full customized solution, we can meet the needs to ensure that the chipper fit perfectly with the customer machinery.



Mobile chipper 806 ST assembled onto an John Deere forwarder



Mobile chipper 806 ST assembled onto an M.A.N truck

Contents

STANDARD MACHINE	4	OPTIONAL EQUIPMENT	19
ALTERNATIVE EQUIPMENT	8	ACCESSORIES	22
INSTALLATION KITS	16		

STANDARD MACHINE

Mobile Chipper 806 ST

The mobile chipper is developed for the production of fuel chips and has a capacity to process full length trees and logs up to a diameter of 50 cm (Max. 40 cm for hardwood). The chipping unit is electronically and hydraulically controlled, powered by its own diesel engine. The unit is installed onto a customer supplied carrier vehicle equipped with a crane for loading brushwood and trees.

The standard machine comes with the BRUKS standard colors which fulfill corrosion class ISO 12944:7/BSK07. Surface according to BRUKS K3.
BRUKS Blue, RAL5005, gloss 75-85
BRUKS Orange, RAL2008, gloss 75-85



Part number	Description
DM806ST	Model DM 806ST

Technical Data 806 ST

Engine	Scania DC13 385A EU Stage IV	368 kW, 500 Hk
Chipper drum diameter	800 mm	
Infeed dimension WxH	850x720 mm	
Adjustable chip length (variants of chip drums)	20-45 mm	
Measurements in transport position with standard chip tube LxWxH	5200 x 2500 x 2560	
Measurements in transport position with long chip tube LxWxH	5980 x 2500 x 2475	
Max. recommended wood diameter	50 cm	40 cm when hard wood

Chipper Unit

A robust chipper housing with hydraulically driven feed unit with a retraction force of four tonnes. The powerful 800 mm upper roller is powered by a built in hydraulic motor. During operation the roller is floating on top of the material but can easily be hydraulically lifted and lowered to press if needed. All rollers have hardened teeth to ensure high durability. When the material has been cut, the

chips are transported through a chip screen, into the hydraulically powered chip accelerator and through the chip tube. The chipper is built to ensure easy and safe maintenance. The knives are easily accessible through the hydraulically operated hood. To ensure high durability, wear parts are exchangeable and made of Hardox steel.

Drum with Two Full Length Knives

A drum for chipping primarily logging residues. The two full length knives ensure superior chip quality as well as high feed speed for high production rates. The chip length is set to 40 mm in the factory, but this can be adjusted between 35-40 mm.

Chip Screen 133 mm

The standard chip screen has an opening of 133 mm between the bars. This screen enables high capacity production allowing some larger pieces of chips to go through.

Infeed Table

The infeed table is equipped with four rollers. The three outer rollers are chain driven by the hydraulically powered inner roller. The rollers have hardened teeth to ensure high durability and high efficient infeed. The design of the infeed table makes it very easy to feed in a variety of materials from logging residues, whole trees to logs. The infeed table is hydraulically raised into transport position. A support is used to secure the feed table in raised position during transport.

Chip Tube

A powerful chip tube specially designed for our chipping units. To facilitate an optimal filling of the chip bin, the tube is equipped with a hydraulically operated control deflector. The chip tube is foldable to enable low transport height. The outer sweep is exchangeable for a good operating economy, in case of wear and tear due to high productivity.

Mounting Frame

A mounting frame section with integrated mounting brackets for chipper and engine installation. Spring-loaded brackets for the carrier vehicle chassis allow certain independent movement of the chipping unit and carrier frame. A fold-down service platform is available for knife exchange and maintenance. A cage with a roof and hatches protects the diesel engine.

Diesel-engine Scania DC13 385A

A powerful stage IV engine with low fuel consumption.

The engine is certified according to EU Stage IV. Complete installation includes side mounted "side by side" radiator, transmission, starter batteries, fuel tank 350 L, AdBlue tank and exhaust system.

Power 368 kW, 500 hp.

Hydraulic System

The hydraulic system is a load sensing type and is powered by a variable displacement pump. The infeed, lifting and dumping of the chip bin is controlled by proportional valves to enable exact operation. Upper and lower infeed units can be controlled individually. Other functions are controlled with an ON/OFF function at a pre-set flow. The chip accelerator is powered by a hydrostatic pump which enables the accelerator to run at a constant speed regardless of the engine rpm. The oil cooler fans are hydraulically powered with the possibility to reverse when cleaning the cooler. There is an electrical pump be used when operating hydraulic functions with the engine switched off, for example when changing knives during maintenance.

Volumes:

Hydraulic tank: 200 L

Complete system: 260 L

Hydraulic oil: Q8 Handel 46

Electrical System

Complete "DASA 5" control system for the chipper and the diesel engine.
Control PC with touch-screen, control panel and control devices in the cab.
Electrical battery switch and emergency switches.

Servicing Accessories

A standard tool kit for the chipper consisting of a torque wrench, knife guide and hand tools for daily maintenance.

Documentation

User manual provided in local language and with original version in Swedish
Spare parts book in English

ALTERNATIVE EQUIPMENT

Drum with Two Full Length Knives

Drum for chipping primarily logging residues. The two full length knives with adjustable chip length ensure superior chip quality as well as high feed speed for high production rates.

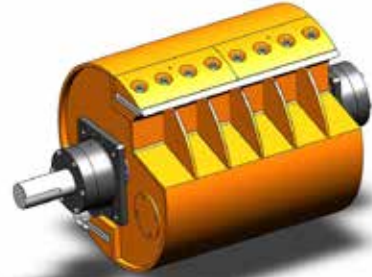

Part number	Description	Adjustable
11036283	Drum with two full length knives	20-35 mm
11135100 (Std.)	Drum with two full length knives	35-40 mm

Roundwood Drum with Two Half Length Knives

Drum for chipping large diameter roundwood, full trees and other challenging material. The half length knife with adjustable chip length, enables the most efficient chipping of rough material. The infeed speed can be slightly lower, but a high production rate will be ensured due to a more consistent infeed of the material. By using half length knives, vibrations as well as other impacts on the chipper are reduced when chipping large size material.

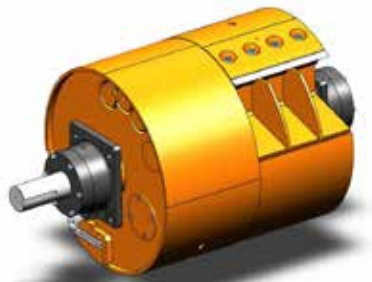

Part number	Description	Adjustable
11135000	Roundwood drum with two half length knives	20-35 mm
11268600	Roundwood drum with two half length knives	35-40 mm

Combination Drum 806

With the combination drum it is easy to switch between chipping with two full length knives and two half length knives (for large roundwood and hardwood). The combination drum must be completed with a knife kit according to the list below.

Part number	Description	Adjustable
01312600	Combination drum 806	40-45 mm

Basic Kit for Two Half Length Knives

Cassettes for knife pockets, reversible wear plates, knife blocks and knives as well as plug cassettes. 2 x 1 configuration.

Supplementary Kit for 01635100

With the combination drum and the basic kit for two half length knives you can also choose a kit that supplements the basic kit of 2 x 1 execution to a set of 2 x 2 knife design. The kit consists of additional knife pockets, wear plates, knife blocks and knives.

Part number	Description
01635100	Basic kit for two half length knives (<i>can be supplemented with kit P/N 01635280</i>)
01635280	Supplementary kit for P/N 01635100

Basic Kit for Two Full Length Knives Split Knife Block

Full cassettes for knife pockets, reversible wear plates, splitted knife blocks and full length knives.

Part number	Description
01638100	Basic kit for two full length knives

Basic Kit for Two Full Length Knives

Full cassettes for knife pockets, reversible wear plates, full length knife block and knives.

Part number	Description
01638180	Basic kit for two full length knives

Basic Kit for Split Full Length Knives (2x2)

Cassettes for knife pockets, reversible wear plates, knife blocks and knives as well as plug cassettes. All in 2 x 2 configuration but with the possibility to complete with plugs for 2 x 1 configuration.

Part number	Description
01635200	Basic kit for split full length knives (2x2)

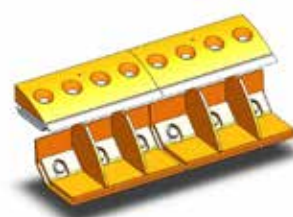
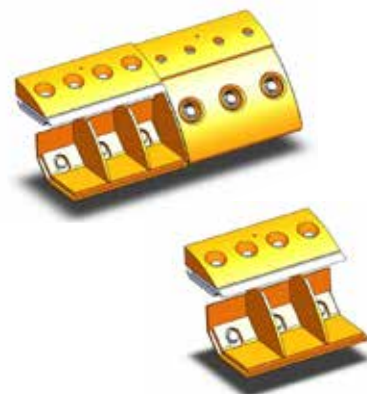
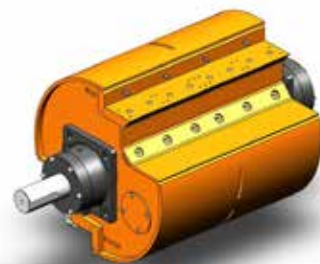

Chip Screens



Chip Screen 40 mm

An extra tight screen with the bars placed close together at a distance of 40 mm (C/C 50 mm) to minimize larger chips and pieces from coming through.

Part number	Description
31599682	Chip screen 806ST C/C=50

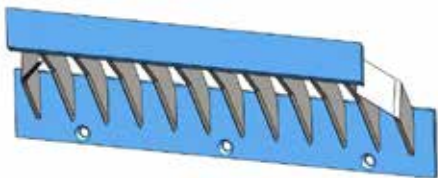

Chip Screen 58 mm

A tight screen with the bars placed close together at a distance of 58 mm (C/C 68 mm) to minimize larger chips and pieces from coming through.

Part number	Description
31599683	Chip screen 806ST C/C=68

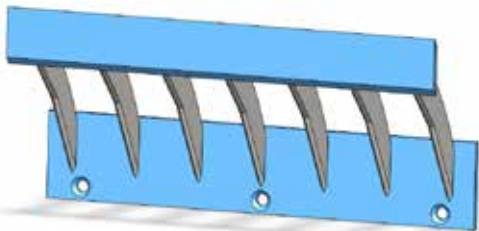

Chip Screen 90 mm

A medium tight screen with the bars placed at a distance of 90 mm (C/C 100 mm) to limit the share of the larger pieces from coming through, but still maintaining a high production capacity.

Part number	Description
31599680	Chip screen 806ST C/C=100

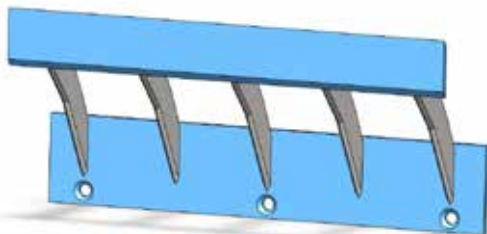

Chip Screen 133 mm

A screen with the bars placed at a distance of 133 mm (C/C 143 mm) to ensure a high production capacity. This screen will only limit the largest pieces from coming through.

Part number	Description
31599600 (std.)	Chip screen 806ST C/C =143

Infeed Tables

Infeed Table with Four Rollers

The infeed table is equipped with four rollers. The outer rollers are chain driven by the hydraulically powered inner roller. The rollers have hardened teeth to ensure high durability and high efficient infeed. The design of the infeed table makes it very easy to feed in a variety of materials from logging residues, whole trees to logs. The infeed table is hydraulically raised into transport position.

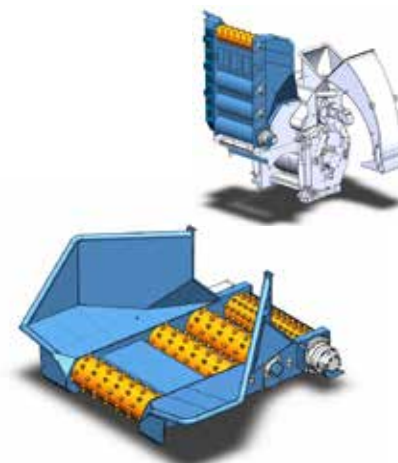

Part number	Description
00813200 (std.)	Infeed table with four rollers

Extra Long Infeed Table

Extra long infeed table equipped with powered rollers. The extra long table has a lower transport height when folded, compared to the standard infeed table. The outer rollers are chain driven by the hydraulically powered inner roller. The rollers have hardened teeth to ensure high durability and high efficient infeed. The design of the infeed table makes it very easy to feed in a variety of materials from logging residues, whole trees to logs. The extra long infeed table can be ordered with four or five rollers.

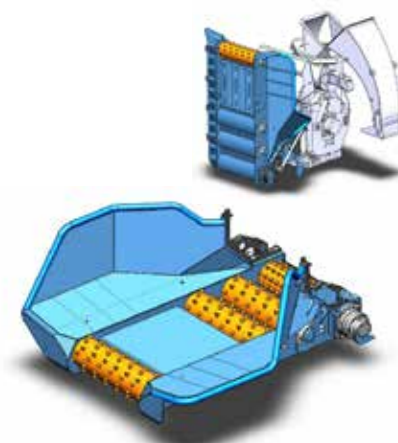

Part number	Description
01614000	Extra long infeed table with four rollers
01614080	Extra long infeed table with five rollers

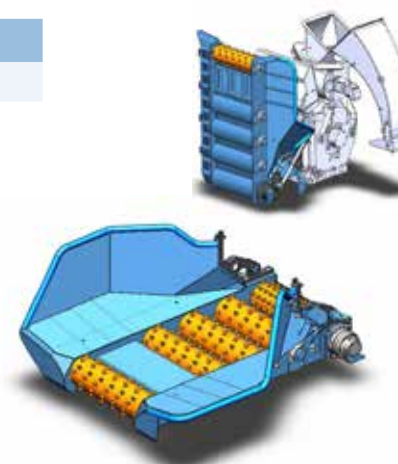

Chip Tubes

Chip Tube

A powerful chip tube specially designed for our chipping units. To facilitate an optimal filling of the chip bin, the tube is equipped with a hydraulically operated control deflector. The chip tube is foldable to enable low transport height. The outer sweep is exchangeable for a good operating economy, in case of wear and tear due to high productivity.

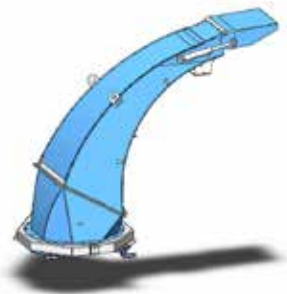

Chip Tube Long and High

A powerful chip tube similar to the standard model but with a longer and higher design for use on a truck. To facilitate a optimal filling of the chip bin the tube is equipped with a hydraulically operated control deflector. The chip tube is foldable to enable low transport height. The outer sweep is exchangeable for a good operating economy, in case of wear and tear due to high productivity.

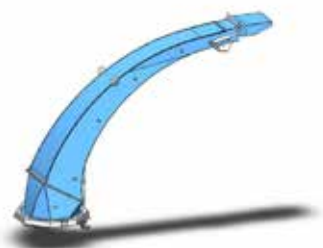

Chip tube with integrated chip accelerator

A chip tube with long range. The chip accelerator is integrated in the chip tube for optimal function. The chip tube is articulated around the accelerator and is adjustable in height. It may be equipped with a hydraulic adjustable chip deflector. This gives good control of the chip output, both near or longer out from the chipper. The tube has an exchangeable outer sweep on the lower part where the wear is greatest.

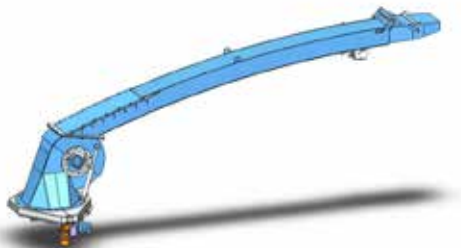

Part number	Description
01671800 (std.)	Chip tube standard
01671900	Chip tube, long high
016720xx	Chip tube with integrated chip accelerator

Optional Chip Deflectors

Standard Chip Deflector

Basic hydraulically operated chip deflector on the chip tube.

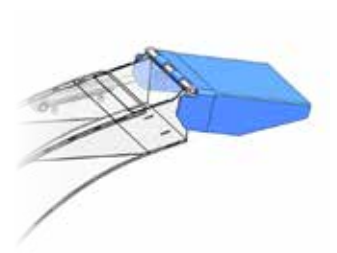

Dual Chip Deflector

Hydraulically operated chip deflector designed with two (dual) deflectors to both effectively control the chips down close to the chipper and give precision control for the chips further away



Part number	Description
00645900 (std.)	Chip deflector standard
01498080	Chip deflector dual

Hydraulic System

The hydraulic system is a load sensing type and is powered by a variable displacement pump. The infeed, lifting and dumping of the chip bin is controlled by proportional valves to enable exact operation. Upper and lower infeed units can be controlled individually. Other functions are controlled with an ON/OFF function at a pre-set flow. The chip accelerator is powered by a hydrostatic pump which enables the accelerator to run at a constant speed regardless of the engine rpm. The oil cooler fans are hydraulically powered with the possibility to reverse when cleaning the cooler. There is an electrical pump be used when operating hydraulic functions with the engine switched off, for example when changing knives during maintenance.

Volumes:

- Hydraulic tank: 200 L
- Complete system: 260 L
- Hydraulic oil: Q8 Handel 46

Hydraulic System 140 cc

The hydraulic system is a load sensing type and is powered by a variable displacement pump. The 140 cc pump have the capacity to supply the chipper feed, cylinder funtions and a medium size crane. Connections for crane (P.T.S.) and a separate cooler with electric fan for crane hydraulic. The infeed, lifting and dumping of the chip bin is controlled by proportional valves to enable exact operation. Upper and lower infeed units can be controlled individually. Other functions are controlled with an ON/OFF function at a pre-set flow. The chip accelerator is powered by a hydrostatic pump which enables the accelerator to run at a constant speed regardless of the engine rpm. The standard oil cooler fan is hydraulically powered with the possibility to reverse when cleaning the cooler. There is an electrical pump be used when operating hydraulic functions with the engine switched off, for example when changing knives during maintenance.

Volumes:

- Hydraulic tank: 200 L
- Complete system: 260 L
- Hydraulic oil: Q8 Handel 46

Part number	Description
01460880 (Std.)	Hudraulic system 806 ST
01460881	Hudraulic system 806 ST 140cc

Hydraulic Oil

Different hydraulic oils can be provided by Bruks, but it is also possible to have a machine filled up with special oil supplied by the customer. In this case the oil must fulfill requirements approved by Bruks.

Part number	Description
99913208 (std.)	Hydraulic oil, Q8 Handel 46
99913207	Hydraulic oil, Handel 32
99913220	Hydraulic oil Neste SE46 Bio
99913241	Hydraulic oil Panolin Hlp Synth 46
99913242	Hydraulic oil JohnDeere 46 Bio
99913245	Hydraulic oil Q8 Holbein Bio Plus
999132XX	Hudraulic oil supplied by the buyer*

* The oil must be of a type that is approved for Bruks hydraulic system and shall be delivered to Bruks in good time before starting up the machine.

Surface Treatment

It is possible to choose a customer unique color for the machine. The customized color must have a RAL code. To ensure maximum surface durability, the colors fulfill corrosion class C2 according to ISO 12944:7/BSK07.

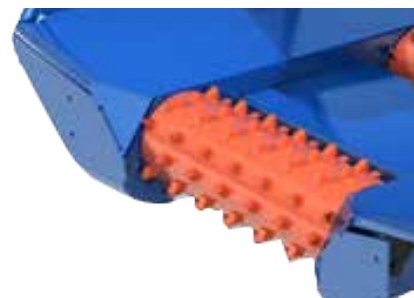

Machine
BRUKS Blue
RAL5005



Rotating parts
BRUKS Orange
RAL2008

Part number	Description	RAL code	Description
DM806BR07	Standard color	BRUKS Blue, RAL5005, gloss 75-85 Bruks Orange, RAL2008, gloss 75-85.	Corrosion class C2 according to ISO 12944:7/BSK07. Surface according to BRUKS K3.
DM806BR99	Customized color		Corrosion class C2 according to ISO 12944:7/BSK07. Surface according to BRUKS K3. Customized RAL color according to agreement with gloss 75-85. Rotating parts RAL2008, gloss 75-85.

INSTALLATION KITS

There are a number of mounting kits available for carrier vehicle installation that make the installation quicker and easier. Each mounting kit is tailor made to match the carrier frame. There is also a kit available for mounting the DASA units inside the cabin. It is also possible to mount a automatic fire extinguishing system onto the installation.

Part number	Description	
DM806MX (std.)	No Assembly on carrier	Assembly on carrier is not included in our scope of delivery.
DM806M	Assembly on carrier	In our scope of delivery is the assembly on the below mentioned type of carrier is included. The assembly is carried out at our workshops in Arbrå.
92923337	Prepared cab assembly	DASA units for the cab are pre-mounted on a plate and cab wiring is connected.

Components for cab assembly

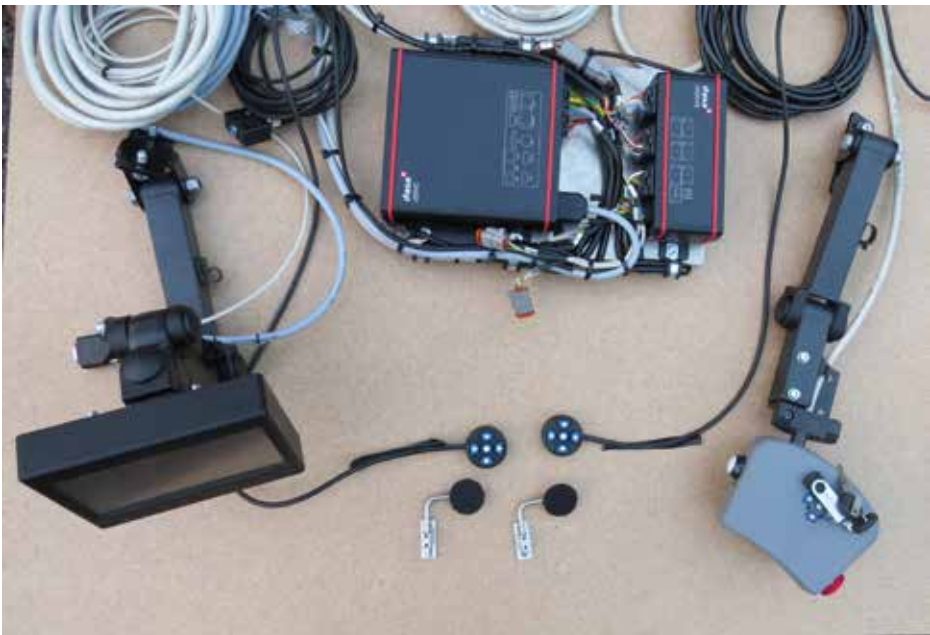

Mounting Kit For Truck Universal

The mounting kits are tailor made by the bodybuilder workshop to fit different types of trucks, forwarders. It is also possible to install the chipper unit onto a demountable platform. The illustrations show examples of different types of installations.

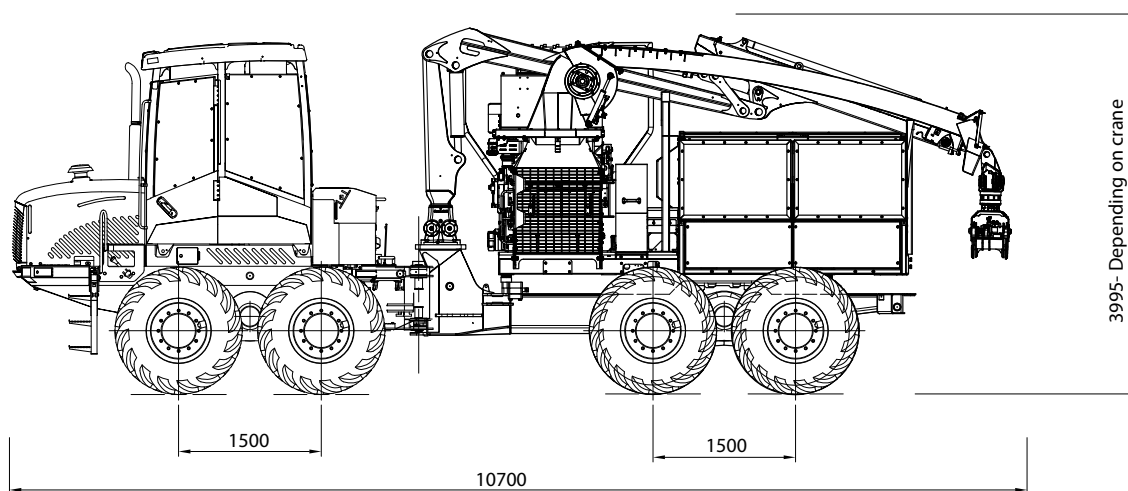
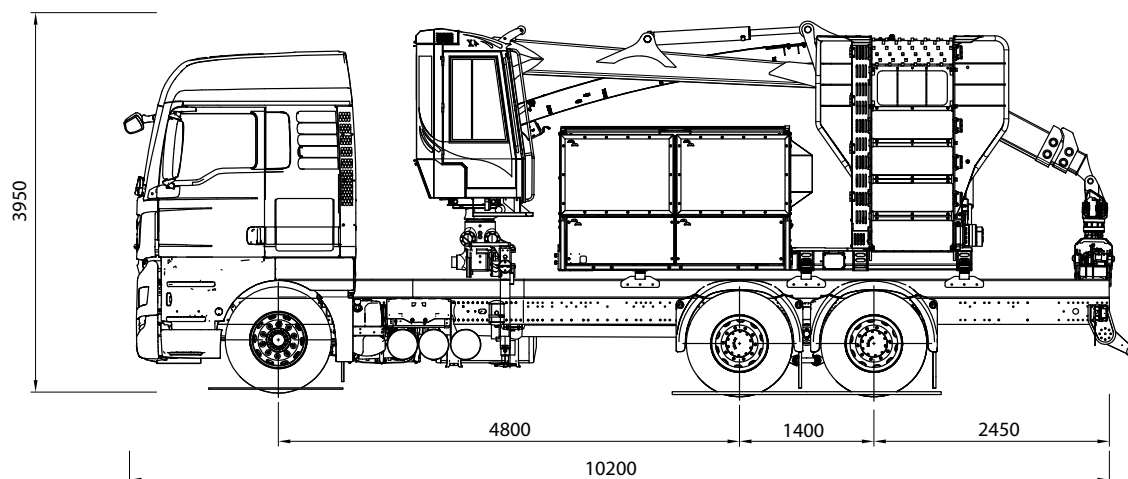

Part number	Description	
01934100	Mounting Kit for Truck, Universal	Universal installation kit for truck mounting.

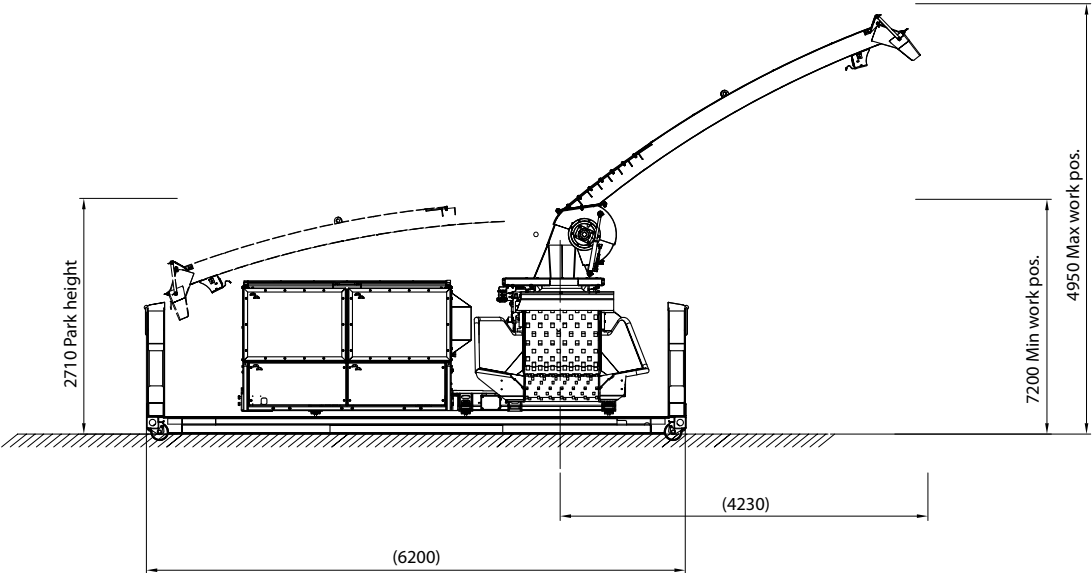

Slewing system

The chipper can be installed with a slewing system that makes it possible to rotate the complete chipper unit.

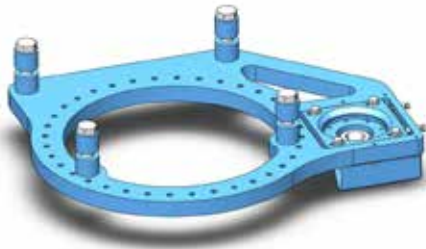
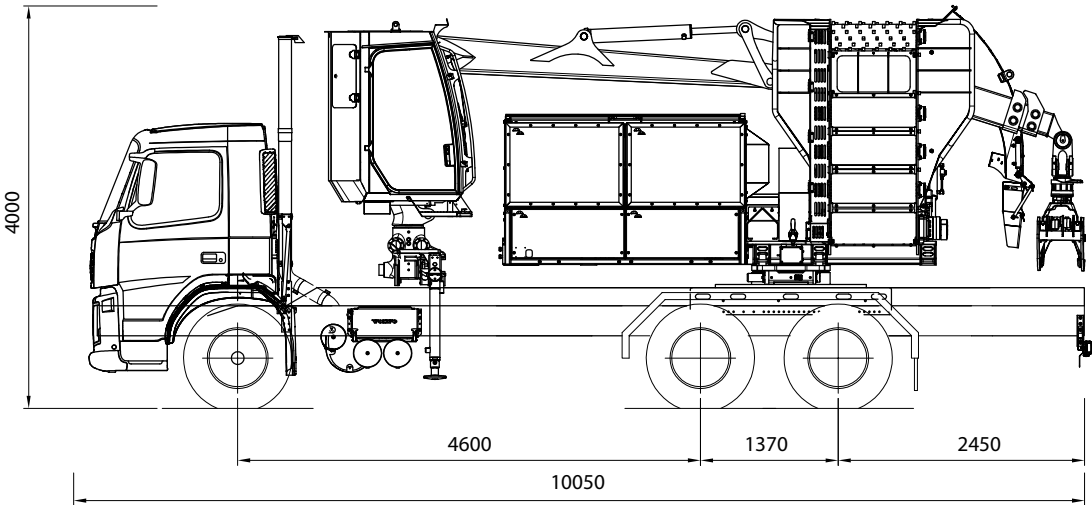

Part number	Description	
01835100	Mounting Plate	Mounting plate for slewing ring and hydraulic motor

OPTIONAL EQUIPMENT



Fire Extinguishing System

Automatic fire extinguishing sprinkler system filled with 40 liters of extinguishing agent DAFO Forrex CV 01

Part number	Description
016664XX	Fire extinguishing system



Foot Pedal Double

With two driver-controlled programmable functions, selectable is upper roll lift, press, feed forward or reverse.

Part number	Description
92926549	Foot pedal double

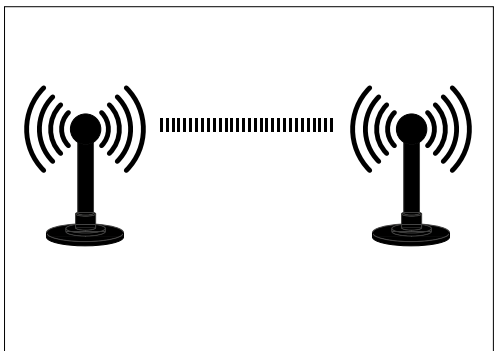

Part number	Description
92922161	Radio control

Radio Control

For remote control of chipping unit by wireless radio link from other vehicle.

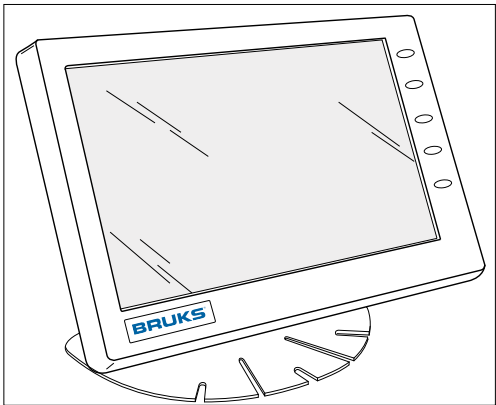

Monitor For Reversing Camera

Wippomatic ECL 750WP, 7 "color LCD display in robust version with very good picture. Including mounting and wiring between the cab and the chipping unit.

Part number	Description
92922162	Monitor for reversing camera



Reversing Camera

Wippomatic ECC-2000 camera with a motorized flap. With mounting into the designated area.

Part number	Description
929221xx	Reversing camera



Knife Box

Space for 4-knives and one anvil. Mounted by the chippers working platform.

Part number	Description
21493580	Knife Box



Engine Preheater

Diesel driven water heater for chipper engine, Webasto Thermo 50 with timer.

Part number	Description
01632900	Engine Preheater



Filling Equipment

Fuel and hydraulic oil filling equipment, including hose with quick joint.

Part number	Description
01807300	Filling pump Hydraulic oil
01663500	Re-filling equipment Diesel

ACCESSORIES

Accessory kits that can be delivered together with the machine

Part number	Description	
41591700	Knife Kit, 1/2 lengths knives	10 pcs of knives. Adjustments screws for knives, 10 pcs 50mm and 10 pcs 80mm.
41591800	Knife Kit, full length knives	10 pcs of knives. Adjustments screws for knives, 10 pcs 50mm and 10 pcs 80mm.

NOTES

Mobile Chipper 806 ST

Global Supplier of Mobile Chippers

In combination with new innovative solutions for production of renewable biomass fuel, our mobile chippers and systems are unique in the process of harvesting the energy material already in the forest.

Leading the Way in Bulk Materials Handling Systems

BRUKS is a global leader in mechanical-engineering and equipment supply for the bulk materials handling industries. Customer service and product performance are at the heart of our corporate culture.

BRUKS®

Mobile Chippers